



MEETS THE CARABINER REQUIREMENTS OF NFPA 1983, INCORPORATED IN THE 2022 EDITION OF NFPA 2500.

- 300090-01 CMC PROSTEEL SCREW-LOCK D GRAY/BRONZE CARABINER, GENERAL USE (G) MBS 48 KN (10,791 LBF)
- 300092-01 CMC PROSTEEL AUTO-LOCK D GRAY/SILVER ANSI CARABINER, GENERAL USE (G) MBS 48 KN (10,791 LBF)
- 300093-01 CMC PROSTEEL SCREW-LOCK OVAL GRAY/BRONZE CARABINER, GENERAL USE (G) MBS 40 KN (8,992 LBF)
- 300094-01 CMC PROSTEEL AUTO-LOCK OVAL GRAY/SILVER ANSI CARABINER, GENERAL USE (G) MBS 40 KN (8,992 LBF)
- 300096-01 CMC/KONG DNA AUTO-LOCK GRAY/SILVER CARABINER, GENERAL USE (G) MBS 40 KN (8,992 LBF)

MEETS THE REQUIREMENTS OF ANSI Z359.12:2019: CONNECTING COMPONENTS FOR PERSONAL FALL ARREST SYSTEMS.

- 300092-01 CMC PROSTEEL AUTO-LOCK D GRAY/SILVER ANSI CARABINER
- 300094-01 CMC PROSTEEL AUTO-LOCK OVAL GRAY/SILVER ANSI CARABINER
- 300095-01 CMC/KONG DNA AUTO-LOCK GRAY/SILVER ANSI CARABINER

Compliance of conformity to ANSI Z359.12:2019 performed by the following notified bodies:

- n° 0123 - TÜV SÜD Product Service GmbH Daimlerstraße 11 - 85748 Garching - Germany (300392 & 300394)
- n° 2008 DOLOMITICERT scarl - zona industriale Villanova - 32013 Longarone (BL) - Italia (300395)

USER INFORMATION

User Information shall be provided to the user of the product. NFPA Standard 1983, incorporated into the 2022 edition of NFPA 2500 recommends separating the User Information from the equipment and retaining the information in a permanent record. The standard also recommends making a copy of the User Information to keep with the equipment and that the information should be referred to before and after each use.

Additional information regarding life safety equipment can be found in NFPA 1500 and NFPA 1858 and NFPA 1983, incorporated in the 2022 edition of NFPA 2500 and the ANSI Z359 series of Fall Protection standards.

LIFESPAN / INSPECTION / RETIREMENT

CMC does not specify an expiration date for hardware because the service life depends greatly on how and where it is used. The type of use, intensity of use, and environment of use are all factors in determining serviceability of the equipment. A single exceptional event can be cause for retirement after one use, such as exposure to sharp edges, extreme temperatures, chemicals, or harsh environments. Remove retired equipment from service and destroy it to prevent further use.

A device must be retired when:

- It fails to pass inspection.
- It fails to function properly.
- It has illegible product markings.
- It shows signs of damage or excessive wear.
- It has been subjected to shock loads, falls, or abnormal use.
- It has been exposed to harsh chemical reagents.
- It has an unknown usage history.
- You have any doubt as to its condition or reliability.
- When it becomes obsolete due to changes in legislation, standards, technique or incompatibility with other equipment.

Find the latest version this manual at cmcpro.com

GENERAL USE (G)
NFPA 2500 (1983), 2022 ED.
ANSI Z359.12 (19)

CMC PROSTEEL CARABINERS
CMC/KONG DNA CARABINERS

CMC

Product No. 300090-01
CMC ProSteel Screw-Lock D Gray/Bronze Carabiner

⚠ WARNINGS

Activities involving the use of this equipment are potentially dangerous. Special knowledge and training are required to use this product. You are responsible for your own actions and decisions. Before using this device, you must:

- Read and understand these user instructions and warnings.
- Familiarize yourself with its capabilities and limitations.
- Be a competent person and/or get specific training in its proper use, or be under the direct supervision of a trained or otherwise competent person.
- Understand and accept the risks involved.

FAILURE TO HEED ANY OF THESE WARNINGS MAY RESULT IN SEVERE INJURY OR DEATH.

Inspect the equipment according to your department's policy for inspecting life safety equipment. CMC recommends a detailed inspection by a competent person at least once every 12 months depending on current regulations and conditions of use. Record the date, inspector name, and inspection results in the equipment log as well as any other relevant information to track the usage history.

Before each use, the user should:

- Confirm the device is functioning properly.
- Verify the presence and legibility of the product markings.
- Verify there is no excessive wear or indications of damage such as deformation, corrosion, sharp edges, cracks, or burrs. Minor nicks or sharp spots may be smoothed with emery cloth or similar.
- Check for the presence of dirt or foreign objects that can affect or prevent normal operation such as grit, sand, rocks, and debris.

During each use, the user should:

- Confirm all pieces of equipment in the system are correctly positioned with respect to each other.
- Monitor the condition of the device and its connections to other equipment in the system.
- Do not allow anything to interfere with the operation of the device or its components.
- Keep foreign objects out of the device.

LIMITATIONS AND PROPER USE

All carabiners are designed to specific performance criteria. Be aware of load limitations, manner used, and proper technique. Do not overload a carabiner. Carabiners can fail under improper use conditions such as cross loading, gate open loading, loading other than major axis, applying a shear or torsional load to the carabiner, etc. If you are not sure of proper application or technique, seek proper training in carabiner use and technical rope application.

To remove the keeper pin (for models so equipped), use the supplied hex wrench to remove the set screw, then pull the pin completely from the carabiner frame. To reinstall, insert the keeper pin through the hole in the gate side of the frame, then ensure the pin is fully seated in the blind hole in the spine side of the frame. Reinstall the set screw, taking care not to overtighten or strip the threads or head. Use a thread locker to ensure the set screw does not back out during use.

COMPATIBILITY

300092-01, 300094-01, and 300095-01 are connecting components in accordance with ANSI/ASSP Z359.12-2019, used to connect two or more pieces of equipment together in Personal Fall Arrest Systems. Ensure compatibility with other components in the fall protection system.

CARRYING, MAINTENANCE & STORAGE

During all use, carrying, storage and transport keep the equipment away from acids, alkalis, rust and strong chemicals. Do not expose the equipment to direct heat, flame or high temperatures. Clean equipment using clean fresh water to remove any dust or debris. Do not use a pressure washer for cleaning. If the equipment gets wet, remove excess moisture and allow to air dry at temperatures between 10° C and 30° C. Lubricate moving parts as needed.

During storage and transport, protect the equipment from heat, direct sunlight, moisture, chemicals, and external loads or impacts. Do not store where the equipment may be exposed to moist air, particularly where dissimilar metals are stored together.

WARRANTY & REPAIRS

If your CMC product has a defect due to workmanship or materials, please contact CMC Customer Support at info@cmcpro.com for warranty information and service.

CMC's warranty does not cover damages caused by improper care, improper use, alterations and modifications, accidental damage or the natural breakdown of material over extended use and time. The equipment should not be modified in any way or altered to allow attachment of additional parts without the manufacturer's written recommendation. If original components are modified or removed from the product, its safety aspects may be restricted.

All repair work shall be performed by the manufacturer. All other work or modifications void the warranty and releases CMC from all liability and responsibility as the manufacturer.

SAMPLE INSPECTION AND MAINTENANCE LOG

The following sample log provides an example of the records that can be maintained by the purchaser or user.

Equipment Inspection and Maintenance Log			
Item _____ # _____		Date in Service _____	
Brand/Model _____		Strength _____	
Date	How Used or Maintained	Comments	Name

Screw-Lock Use

Auto-Lock Use

⚠ Do not use if gate fails to lock or open properly.

CMC

CMC

CMC Rescue, Inc.
6740 Cortona Drive, Goleta, CA 93117, USA
805-562-9120 / 800-235-5741
cmcpro.com
ISO 9001 Certified
© CMC Rescue, Inc. All rights reserved
CMC and **XX** are registered marks of CMC Rescue Inc.
CMC Control No.: 30009X-01IN01_Rev00

NFPA 2500 (2022 ED) “G”		NFPA 2500 (2022 ED) “G” AND ANSI Z359.12 (19)	ANSI Z359.12 (19)

Dimension	300090-01		300092-01		300093-01		300094-01		300095-01		300096-01	
	mm	in	mm	in	mm	in	mm	in	mm	in	mm	in
	76.5	3.01	76.5	3.01	62	2.44	62	2.44	65	2.56	65	2.56
	114	4.49	114	4.49	110	4.33	110	4.33	108	4.25	108	4.25
	26	1.02	25	0.98	21	0.78	20	0.78	18	0.71	19	0.75

Weight	300090-01		300092-01		300093-01		300094-01		300095-01		300096-01	
	g	oz	g	oz	g	oz	g	oz	g	oz	g	oz
	240	8.5	265	9.3	205	7.2	220	7.8	230	8.1	215	7.6

Strength	300090-01		300092-01		300093-01		300094-01		300095-01		300096-01	
	kN	lbf	kN	lbf	kN	lbf	kN	lbf	kN	lbf	kN	lbf
	48	10,791	48	10,791	40	8,992	40	8,992	40	8,992	40	8,992
	17	3,822	17	3,822	12	2,698	12	2,698	11	2,473	11	2,473
	16	3,597	20	4,496	16	3597	20	4,496	16	3,597	16	3,597
	\	\	16	3,597	\	\	16	3,597	16	3,597	\	\
	\	\	16	3,597	\	\	16	3,597	16	3,597	\	\

XX CMC | CMC PROSTEEL AND CMC/KONG DNA CARABINERS USER MANUAL | CMCPRO.COM



MEETS THE CARABINER REQUIREMENTS OF NFPA 1983, INCORPORATED IN THE 2022 EDITION OF NFPA 2500.

- 300090-01 CMC PROSTEEL SCREW-LOCK D GRAY/BRONZE CARABINER, GENERAL USE (G) MBS 48 KN (10,791 LBF)
- 300092-01 CMC PROSTEEL AUTO-LOCK D GRAY/SILVER ANSI CARABINER, GENERAL USE (G) MBS 48 KN (10,791 LBF)
- 300093-01 CMC PROSTEEL SCREW-LOCK OVAL GRAY/BRONZE CARABINER, GENERAL USE (G) MBS 40 KN (8,992 LBF)
- 300094-01 CMC PROSTEEL AUTO-LOCK OVAL GRAY/SILVER ANSI CARABINER, GENERAL USE (G) MBS 40 KN (8,992 LBF)
- 300096-01 CMC/KONG DNA AUTO-LOCK GRAY/SILVER CARABINER, GENERAL USE (G) MBS 40 KN (8,992 LBF)

MEETS THE REQUIREMENTS OF ANSI Z359.12:2019: CONNECTING COMPONENTS FOR PERSONAL FALL ARREST SYSTEMS.

- 300092-01 CMC PROSTEEL AUTO-LOCK D GRAY/SILVER ANSI CARABINER
- 300094-01 CMC PROSTEEL AUTO-LOCK OVAL GRAY/SILVER ANSI CARABINER
- 300095-01 CMC/KONG DNA AUTO-LOCK GRAY/SILVER ANSI CARABINER

Compliance of conformity to ANSI Z359.12:2019 performed by the following notified bodies:

- n° 0123 - TÜV SÜD Product Service GmbH Daimlerstraße 11 - 85748 Garching - Germany (300392 & 300394)
- n° 2008 DOLOMITICERT scarl - zona industriale Villanova - 32013 Longarone (BL) - Italia (300395)

USER INFORMATION

User Information shall be provided to the user of the product. NFPA Standard 1983, incorporated into the 2022 edition of NFPA 2500 recommends separating the User Information from the equipment and retaining the information in a permanent record. The standard also recommends making a copy of the User Information to keep with the equipment and that the information should be referred to before and after each use.

Additional information regarding life safety equipment can be found in NFPA 1500 and NFPA 1858 and NFPA 1983, incorporated in the 2022 edition of NFPA 2500 and the ANSI Z359 series of Fall Protection standards.

LIFESPAN / INSPECTION / RETIREMENT

CMC does not specify an expiration date for hardware because the service life depends greatly on how and where it is used. The type of use, intensity of use, and environment of use are all factors in determining serviceability of the equipment. A single exceptional event can be cause for retirement after one use, such as exposure to sharp edges, extreme temperatures, chemicals, or harsh environments. Remove retired equipment from service and destroy it to prevent further use.

A device must be retired when:

- It fails to pass inspection.
- It fails to function properly.
- It has illegible product markings.
- It shows signs of damage or excessive wear.
- It has been subjected to shock loads, falls, or abnormal use.
- It has been exposed to harsh chemical reagents.
- It has an unknown usage history.
- You have any doubt as to its condition or reliability.
- When it becomes obsolete due to changes in legislation, standards, technique or incompatibility with other equipment.

Inspect the equipment according to your department's policy for inspecting life safety equipment. CMC recommends a detailed inspection by a competent person at least once every 12 months depending on current regulations and conditions of use. Record the date, inspector name, and inspection results in the equipment log as well as any other relevant information to track the usage history.

Before each use, the user should:

- Confirm the device is functioning properly.
- Verify the presence and legibility of the product markings.
- Verify there is no excessive wear or indications of damage such as deformation, corrosion, sharp edges, cracks, or burrs. Minor nicks or sharp spots may be smoothed with emery cloth or similar.
- Check for the presence of dirt or foreign objects that can affect or prevent normal operation such as grit, sand, rocks, and debris.

During each use, the user should:

- Confirm all pieces of equipment in the system are correctly positioned with respect to each other.
- Monitor the condition of the device and its connections to other equipment in the system.
- Do not allow anything to interfere with the operation of the device or its components.
- Keep foreign objects out of the device.

LIMITATIONS AND PROPER USE

All carabiners are designed to specific performance criteria. Be aware of load limitations, manner used, and proper technique. Do not overload a carabiner. Carabiners can fail under improper use conditions such as cross loading, gate open loading, loading other than major axis, applying a shear or torsional load to the carabiner, etc. If you are not sure of proper application or technique, seek proper training in carabiner use and technical rope application.

To remove the keeper pin (for models so equipped), use the supplied hex wrench to remove the set screw, then pull the pin completely from the carabiner frame. To reinstall, insert the keeper pin through the hole in the gate side of the frame, then ensure the pin is fully seated in the blind hole in the spine side of the frame. Reinstall the set screw, taking care not to overtighten or strip the threads or head. Use a thread locker to ensure the set screw does not back out during use.

COMPATIBILITY

300092-01, 300094-01, and 300095-01 are connecting components in accordance with ANSI/ASSP Z359.12-2019, used to connect two or more pieces of equipment together in Personal Fall Arrest Systems. Ensure compatibility with other components in the fall protection system.

CARRYING, MAINTENANCE & STORAGE

During all use, carrying, storage and transport keep the equipment away from acids, alkalis, rust and strong chemicals. Do not expose the equipment to direct heat, flame or high temperatures. Clean equipment using clean fresh water to remove any dust or debris. Do not use a pressure washer for cleaning. If the equipment gets wet, remove excess moisture and allow to air dry at temperatures between 10° C and 30° C. Lubricate moving parts as needed.

During storage and transport, protect the equipment from heat, direct sunlight, moisture, chemicals, and external loads or impacts. Do not store where the equipment may be exposed to moist air, particularly where dissimilar metals are stored together.

WARRANTY & REPAIRS

If your CMC product has a defect due to workmanship or materials, please contact CMC Customer Support at info@cmcpro.com for warranty information and service.

CMC's warranty does not cover damages caused by improper care, improper use, alterations and modifications, accidental damage or the natural breakdown of material over extended use and time. The equipment should not be modified in any way or altered to allow attachment of additional parts without the manufacturer's written recommendation. If original components are modified or removed from the product, its safety aspects may be restricted.

All repair work shall be performed by the manufacturer. All other work or modifications void the warranty and releases CMC from all liability and responsibility as the manufacturer.

SAMPLE INSPECTION AND MAINTENANCE LOG

The following sample log provides an example of the records that can be maintained by the purchaser or user.

Equipment Inspection and Maintenance Log			
Item _____ # _____		Date in Service _____	
Brand/Model _____		Strength _____	
Date	How Used or Maintained	Comments	Name

Screw-Lock Use

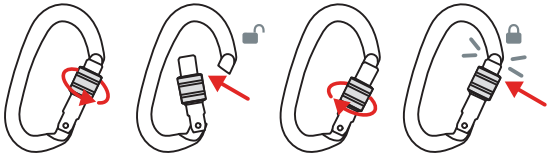

(1)Unscrew gate to unlock (2)Push gate in to open (3)Screw gate to close (4)Confirm gate locking

Auto-Lock Use

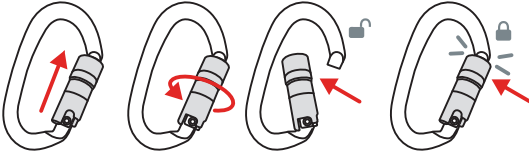

(1)Push gate up (2)Twist gate to unlock (3)Push Gate in to open (4)Release Gate to Lock (5)Confirm Gate Locking

⚠ Do not use if gate fails to lock or open properly.



CMC Rescue, Inc.
6740 Cortona Drive, Goleta, CA 93117, USA
805-562-9120 / 800-235-5741
cmcpro.com
ISO 9001 Certified
© CMC Rescue, Inc. All rights reserved
CMC and **XX** are registered marks of CMC Rescue Inc.
CMC Control No.: 30009X-01IN01_Rev00

NFPA 2500 (2022 ED) “G”

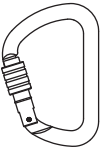

300090-01

CMC ProSteel Screw-Lock D Gray/
Bronze Carabiner

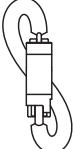

300096-01

CMC/Kong DNA Auto-Lock Gray/Silver
Carabiner

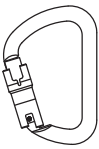

300092-01

CMC ProSteel Auto-Lock D Gray/Silver
ANSI Carabiner

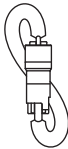

300095-01

CMC/Kong DNA Auto-Lock Gray/Silver
ANSI Carabiner

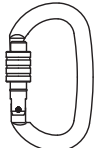

300093-01

CMC ProSteel Screw-Lock Oval Gray/
Bronze Carabiner

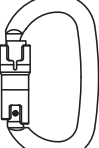

300094-01

CMC ProSteel Auto-Lock Oval Gray/
Silver ANSI Carabiner

Dimension	300090-01		300092-01		300093-01		300094-01		300095-01		300096-01	
	mm	in	mm	in	mm	in	mm	in	mm	in	mm	in
	76.5	3.01	76.5	3.01	62	2.44	62	2.44	65	2.56	65	2.56
	114	4.49	114	4.49	110	4.33	110	4.33	108	4.25	108	4.25
	26	1.02	25	0.98	21	0.78	20	0.78	18	0.71	19	0.75

Weight	300090-01		300092-01		300093-01		300094-01		300095-01		300096-01	
	g	oz	g	oz	g	oz	g	oz	g	oz	g	oz
	240	8.5	265	9.3	205	7.2	220	7.8	230	8.1	215	7.6

Strength	300090-01		300092-01		300093-01		300094-01		300095-01		300096-01	
	kN	lbf	kN	lbf	kN	lbf	kN	lbf	kN	lbf	kN	lbf
	48	10,791	48	10,791	40	8,992	40	8,992	40	8,992	40	8,992
	17	3,822	17	3,822	12	2,698	12	2,698	11	2,473	11	2,473
	16	3,597	20	4,496	16	3597	20	4,496	16	3,597	16	3,597
	\	\	16	3,597	\	\	16	3,597	16	3,597	\	\
	\	\	16	3,597	\	\	16	3,597	16	3,597	\	\

⚠ WARNINGS

Activities involving the use of this equipment are potentially dangerous. Special knowledge and training are required to use this product. You are responsible for your own actions and decisions. Before using this device, you must:

- Read and understand these user instructions and warnings.
- Familiarize yourself with its capabilities and limitations.
- Be a competent person and/or get specific training in its proper use, or be under the direct supervision of a trained or otherwise competent person.
- Understand and accept the risks involved.

FAILURE TO HEED ANY OF THESE WARNINGS MAY RESULT IN SEVERE INJURY OR DEATH.



MEETS THE CARABINER REQUIREMENTS OF NFPA 1983, INCORPORATED IN THE 2022 EDITION OF NFPA 2500.

- 300090-01 CMC PROSTEEL SCREW-LOCK D GRAY/BRONZE CARABINER, GENERAL USE (G) MBS 48 KN (10,791 LBF)
- 300092-01 CMC PROSTEEL AUTO-LOCK D GRAY/SILVER ANSI CARABINER, GENERAL USE (G) MBS 48 KN (10,791 LBF)
- 300093-01 CMC PROSTEEL SCREW-LOCK OVAL GRAY/BRONZE CARABINER, GENERAL USE (G) MBS 40 KN (8,992 LBF)
- 300094-01 CMC PROSTEEL AUTO-LOCK OVAL GRAY/SILVER ANSI CARABINER, GENERAL USE (G) MBS 40 KN (8,992 LBF)
- 300096-01 CMC/KONG DNA AUTO-LOCK GRAY/SILVER CARABINER, GENERAL USE (G) MBS 40 KN (8,992 LBF)

MEETS THE REQUIREMENTS OF ANSI Z359.12:2019: CONNECTING COMPONENTS FOR PERSONAL FALL ARREST SYSTEMS.

- 300092-01 CMC PROSTEEL AUTO-LOCK D GRAY/SILVER ANSI CARABINER
- 300094-01 CMC PROSTEEL AUTO-LOCK OVAL GRAY/SILVER ANSI CARABINER
- 300095-01 CMC/KONG DNA AUTO-LOCK GRAY/SILVER ANSI CARABINER

Compliance of conformity to ANSI Z359.12:2019 performed by the following notified bodies:

- n° 0123 - TÜV SÜD Product Service GmbH Daimlerstraße 11 - 85748 Garching - Germany (300392 & 300394)
- n° 2008 DOLOMITICERT scarl - zona industriale Villanova - 32013 Longarone (BL) - Italia (300395)

USER INFORMATION

User Information shall be provided to the user of the product. NFPA Standard 1983, incorporated into the 2022 edition of NFPA 2500 recommends separating the User Information from the equipment and retaining the information in a permanent record. The standard also recommends making a copy of the User Information to keep with the equipment and that the information should be referred to before and after each use.

Additional information regarding life safety equipment can be found in NFPA 1500 and NFPA 1858 and NFPA 1983, incorporated in the 2022 edition of NFPA 2500 and the ANSI Z359 series of Fall Protection standards.

LIFESPAN / INSPECTION / RETIREMENT

CMC does not specify an expiration date for hardware because the service life depends greatly on how and where it is used. The type of use, intensity of use, and environment of use are all factors in determining serviceability of the equipment. A single exceptional event can be cause for retirement after one use, such as exposure to sharp edges, extreme temperatures, chemicals, or harsh environments. Remove retired equipment from service and destroy it to prevent further use.

A device must be retired when:

- It fails to pass inspection.
- It fails to function properly.
- It has illegible product markings.
- It shows signs of damage or excessive wear.
- It has been subjected to shock loads, falls, or abnormal use.
- It has been exposed to harsh chemical reagents.
- It has an unknown usage history.
- You have any doubt as to its condition or reliability.
- When it becomes obsolete due to changes in legislation, standards, technique or incompatibility with other equipment.

Inspect the equipment according to your department's policy for inspecting life safety equipment. CMC recommends a detailed inspection by a competent person at least once every 12 months depending on current regulations and conditions of use. Record the date, inspector name, and inspection results in the equipment log as well as any other relevant information to track the usage history.

Before each use, the user should:

- Confirm the device is functioning properly.
- Verify the presence and legibility of the product markings.
- Verify there is no excessive wear or indications of damage such as deformation, corrosion, sharp edges, cracks, or burrs. Minor nicks or sharp spots may be smoothed with emery cloth or similar.
- Check for the presence of dirt or foreign objects that can affect or prevent normal operation such as grit, sand, rocks, and debris.

During each use, the user should:

- Confirm all pieces of equipment in the system are correctly positioned with respect to each other.
- Monitor the condition of the device and its connections to other equipment in the system.
- Do not allow anything to interfere with the operation of the device or its components.
- Keep foreign objects out of the device.

LIMITATIONS AND PROPER USE

All carabiners are designed to specific performance criteria. Be aware of load limitations, manner used, and proper technique. Do not overload a carabiner. Carabiners can fail under improper use conditions such as cross loading, gate open loading, loading other than major axis, applying a shear or torsional load to the carabiner, etc. If you are not sure of proper application or technique, seek proper training in carabiner use and technical rope application.

To remove the keeper pin (for models so equipped), use the supplied hex wrench to remove the set screw, then pull the pin completely from the carabiner frame. To reinstall, insert the keeper pin through the hole in the gate side of the frame, then ensure the pin is fully seated in the blind hole in the spine side of the frame. Reinstall the set screw, taking care not to overtighten or strip the threads or head. Use a thread locker to ensure the set screw does not back out during use.

COMPATIBILITY

300092-01, 300094-01, and 300095-01 are connecting components in accordance with ANSI/ASSP Z359.12-2019, used to connect two or more pieces of equipment together in Personal Fall Arrest Systems. Ensure compatibility with other components in the fall protection system.

CARRYING, MAINTENANCE & STORAGE

During all use, carrying, storage and transport keep the equipment away from acids, alkalis, rust and strong chemicals. Do not expose the equipment to direct heat, flame or high temperatures. Clean equipment using clean fresh water to remove any dust or debris. Do not use a pressure washer for cleaning. If the equipment gets wet, remove excess moisture and allow to air dry at temperatures between 10° C and 30° C. Lubricate moving parts as needed. During storage and transport, protect the equipment from heat, direct sunlight, moisture, chemicals, and external loads or impacts. Do not store where the equipment may be exposed to moist air, particularly where dissimilar metals are stored together.

WARRANTY & REPAIRS

If your CMC product has a defect due to workmanship or materials, please contact CMC Customer Support at info@cmcprou.com for warranty information and service. CMC's warranty does not cover damages caused by improper care, improper use, alterations and modifications, accidental damage or the natural breakdown of material over extended use and time. The equipment should not be modified in any way or altered to allow attachment of additional parts without the manufacturer's written recommendation. If original components are modified or removed from the product, its safety aspects may be restricted. All repair work shall be performed by the manufacturer. All other work or modifications void the warranty and releases CMC from all liability and responsibility as the manufacturer.

SAMPLE INSPECTION AND MAINTENANCE LOG

The following sample log provides an example of the records that can be maintained by the purchaser or user.

Equipment Inspection and Maintenance Log			
Item _____ # _____		Date in Service _____	
Brand/Model _____		Strength _____	
Date	How Used or Maintained	Comments	Name

Screw-Lock Use

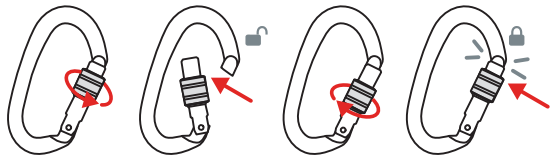

(1)Unscrew gate to unlock (2)Push gate in to open (3)Screw gate to close (4)Confirm gate locking

Auto-Lock Use

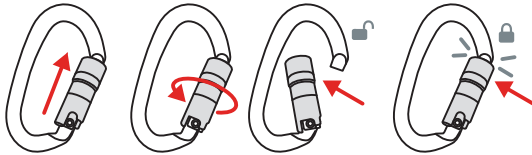

(1)Push gate up (2)Twist gate to unlock (3)Push Gate in to open (4)Release Gate to Lock (5)Confirm Gate Locking

⚠ Do not use if gate fails to lock or open properly.



CMC Rescue, Inc.
6740 Cortona Drive, Goleta, CA 93117, USA
805-562-9120 / 800-235-5741
cmcprou.com
ISO 9001 Certified
© CMC Rescue, Inc. All rights reserved
CMC and **XX** are registered marks of CMC Rescue Inc.
CMC Control No.: 30009X-01IN01_Rev00

NFPA 2500 (2022 ED) “G”

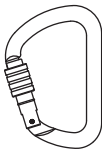

300090-01
CMC ProSteel Screw-Lock D Gray/
Bronze Carabiner

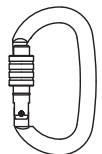

300093-01
CMC ProSteel Screw-Lock Oval Gray/
Bronze Carabiner

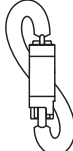

300096-01
CMC/Kong DNA Auto-Lock Gray/Silver
Carabiner

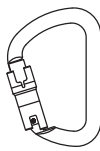

300092-01
CMC ProSteel Auto-Lock D Gray/Silver
ANSI Carabiner

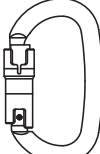

300094-01
CMC ProSteel Auto-Lock Oval Gray/
Silver ANSI Carabiner

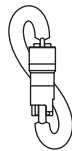

300095-01
CMC/Kong DNA Auto-Lock Gray/Silver
ANSI Carabiner

Dimension	300090-01		300092-01		300093-01		300094-01		300095-01		300096-01	
	mm	in	mm	in	mm	in	mm	in	mm	in	mm	in
	76.5	3.01	76.5	3.01	62	2.44	62	2.44	65	2.56	65	2.56
	114	4.49	114	4.49	110	4.33	110	4.33	108	4.25	108	4.25
	26	1.02	25	0.98	21	0.78	20	0.78	18	0.71	19	0.75

Weight	300090-01		300092-01		300093-01		300094-01		300095-01		300096-01	
	g	oz	g	oz	g	oz	g	oz	g	oz	g	oz
	240	8.5	265	9.3	205	7.2	220	7.8	230	8.1	215	7.6

Strength	300090-01		300092-01		300093-01		300094-01		300095-01		300096-01	
	kN	lbf	kN	lbf	kN	lbf	kN	lbf	kN	lbf	kN	lbf
	48	10,791	48	10,791	40	8,992	40	8,992	40	8,992	40	8,992
	17	3,822	17	3,822	12	2,698	12	2,698	11	2,473	11	2,473
	16	3,597	20	4,496	16	3597	20	4,496	16	3,597	16	3,597
	\	\	16	3,597	\	\	16	3,597	16	3,597	\	\
	\	\	16	3,597	\	\	16	3,597	16	3,597	\	\

⚠ WARNINGS

Activities involving the use of this equipment are potentially dangerous. Special knowledge and training are required to use this product. You are responsible for your own actions and decisions. Before using this device, you must:

- Read and understand these user instructions and warnings.
- Familiarize yourself with its capabilities and limitations.
- Be a competent person and/or get specific training in its proper use, or be under the direct supervision of a trained or otherwise competent person.
- Understand and accept the risks involved.

FAILURE TO HEED ANY OF THESE WARNINGS MAY RESULT IN SEVERE INJURY OR DEATH.



MEETS THE CARABINER REQUIREMENTS OF NFPA 1983, INCORPORATED IN THE 2022 EDITION OF NFPA 2500.

- 300090-01 CMC PROSTEEL SCREW-LOCK D GRAY/BRONZE CARABINER, GENERAL USE (G) MBS 48 KN (10,791 LBF)
- 300092-01 CMC PROSTEEL AUTO-LOCK D GRAY/SILVER ANSI CARABINER, GENERAL USE (G) MBS 48 KN (10,791 LBF)
- 300093-01 CMC PROSTEEL SCREW-LOCK OVAL GRAY/BRONZE CARABINER, GENERAL USE (G) MBS 40 KN (8,992 LBF)
- 300094-01 CMC PROSTEEL AUTO-LOCK OVAL GRAY/SILVER ANSI CARABINER, GENERAL USE (G) MBS 40 KN (8,992 LBF)
- 300096-01 CMC/KONG DNA AUTO-LOCK GRAY/SILVER CARABINER, GENERAL USE (G) MBS 40 KN (8,992 LBF)

MEETS THE REQUIREMENTS OF ANSI Z359.12:2019: CONNECTING COMPONENTS FOR PERSONAL FALL ARREST SYSTEMS.

- 300092-01 CMC PROSTEEL AUTO-LOCK D GRAY/SILVER ANSI CARABINER
- 300094-01 CMC PROSTEEL AUTO-LOCK OVAL GRAY/SILVER ANSI CARABINER
- 300095-01 CMC/KONG DNA AUTO-LOCK GRAY/SILVER ANSI CARABINER

Compliance of conformity to ANSI Z359.12:2019 performed by the following notified bodies:

- n° 0123 - TÜV SÜD Product Service GmbH Daimlerstraße 11 - 85748 Garching - Germany (300392 & 300394)
- n° 2008 DOLOMITICERT scarl - zona industriale Villanova - 32013 Longarone (BL) - Italia (300395)

USER INFORMATION

User Information shall be provided to the user of the product. NFPA Standard 1983, incorporated into the 2022 edition of NFPA 2500 recommends separating the User Information from the equipment and retaining the information in a permanent record. The standard also recommends making a copy of the User Information to keep with the equipment and that the information should be referred to before and after each use.

Additional information regarding life safety equipment can be found in NFPA 1500 and NFPA 1858 and NFPA 1983, incorporated in the 2022 edition of NFPA 2500 and the ANSI Z359 series of Fall Protection standards.

LIFESPAN / INSPECTION / RETIREMENT

CMC does not specify an expiration date for hardware because the service life depends greatly on how and where it is used. The type of use, intensity of use, and environment of use are all factors in determining serviceability of the equipment. A single exceptional event can be cause for retirement after one use, such as exposure to sharp edges, extreme temperatures, chemicals, or harsh environments. Remove retired equipment from service and destroy it to prevent further use.

A device must be retired when:

- It fails to pass inspection.
- It fails to function properly.
- It has illegible product markings.
- It shows signs of damage or excessive wear.
- It has been subjected to shock loads, falls, or abnormal use.
- It has been exposed to harsh chemical reagents.
- It has an unknown usage history.
- You have any doubt as to its condition or reliability.
- When it becomes obsolete due to changes in legislation, standards, technique or incompatibility with other equipment.

Inspect the equipment according to your department's policy for inspecting life safety equipment. CMC recommends a detailed inspection by a competent person at least once every 12 months depending on current regulations and conditions of use. Record the date, inspector name, and inspection results in the equipment log as well as any other relevant information to track the usage history.

Before each use, the user should:

- Confirm the device is functioning properly.
- Verify the presence and legibility of the product markings.
- Verify there is no excessive wear or indications of damage such as deformation, corrosion, sharp edges, cracks, or burrs. Minor nicks or sharp spots may be smoothed with emery cloth or similar.
- Check for the presence of dirt or foreign objects that can affect or prevent normal operation such as grit, sand, rocks, and debris.

During each use, the user should:

- Confirm all pieces of equipment in the system are correctly positioned with respect to each other.
- Monitor the condition of the device and its connections to other equipment in the system.
- Do not allow anything to interfere with the operation of the device or its components.
- Keep foreign objects out of the device.

LIMITATIONS AND PROPER USE

All carabiners are designed to specific performance criteria. Be aware of load limitations, manner used, and proper technique. Do not overload a carabiner. Carabiners can fail under improper use conditions such as cross loading, gate open loading, loading other than major axis, applying a shear or torsional load to the carabiner, etc. If you are not sure of proper application or technique, seek proper training in carabiner use and technical rope application.

To remove the keeper pin (for models so equipped), use the supplied hex wrench to remove the set screw, then pull the pin completely from the carabiner frame. To reinstall, insert the keeper pin through the hole in the gate side of the frame, then ensure the pin is fully seated in the blind hole in the spine side of the frame. Reinstall the set screw, taking care not to overtighten or strip the threads or head. Use a thread locker to ensure the set screw does not back out during use.

COMPATIBILITY

300092-01, 300094-01, and 300095-01 are connecting components in accordance with ANSI/ASSP Z359.12-2019, used to connect two or more pieces of equipment together in Personal Fall Arrest Systems. Ensure compatibility with other components in the fall protection system.

CARRYING, MAINTENANCE & STORAGE

During all use, carrying, storage and transport keep the equipment away from acids, alkalis, rust and strong chemicals. Do not expose the equipment to direct heat, flame or high temperatures. Clean equipment using clean fresh water to remove any dust or debris. Do not use a pressure washer for cleaning. If the equipment gets wet, remove excess moisture and allow to air dry at temperatures between 10° C and 30° C. Lubricate moving parts as needed.

During storage and transport, protect the equipment from heat, direct sunlight, moisture, chemicals, and external loads or impacts. Do not store where the equipment may be exposed to moist air, particularly where dissimilar metals are stored together.

WARRANTY & REPAIRS

If your CMC product has a defect due to workmanship or materials, please contact CMC Customer Support at info@cmcpro.com for warranty information and service.

CMC's warranty does not cover damages caused by improper care, improper use, alterations and modifications, accidental damage or the natural breakdown of material over extended use and time. The equipment should not be modified in any way or altered to allow attachment of additional parts without the manufacturer's written recommendation. If original components are modified or removed from the product, its safety aspects may be restricted.

All repair work shall be performed by the manufacturer. All other work or modifications void the warranty and releases CMC from all liability and responsibility as the manufacturer.

SAMPLE INSPECTION AND MAINTENANCE LOG

The following sample log provides an example of the records that can be maintained by the purchaser or user.

Equipment Inspection and Maintenance Log			
Item _____ # _____		Date in Service _____	
Brand/Model _____		Strength _____	
Date	How Used or Maintained	Comments	Name

Screw-Lock Use

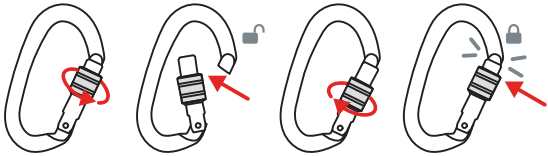

(1)Unscrew gate to unlock (2)Push gate in to open (3)Screw gate to close (4)Confirm gate locking

Auto-Lock Use

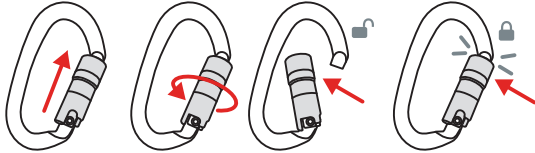

(1)Push gate up (2)Twist gate to unlock (3)Push Gate in to open (4)Release Gate to Lock (5)Confirm Gate Locking

⚠ Do not use if gate fails to lock or open properly.



CMC Rescue, Inc.
6740 Cortona Drive, Goleta, CA 93117, USA
805-562-9120 / 800-235-5741
cmcpro.com
ISO 9001 Certified
© CMC Rescue, Inc. All rights reserved
CMC and **XX** are registered marks of CMC Rescue Inc.
CMC Control No.: 30009X-01IN01_Rev00

NFPA 2500 (2022 ED) “G”

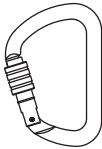

300090-01
CMC ProSteel Screw-Lock D Gray/
Bronze Carabiner

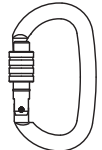

300093-01
CMC ProSteel Screw-Lock Oval Gray/
Bronze Carabiner

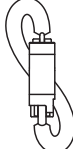

300096-01
CMC/Kong DNA Auto-Lock Gray/Silver
Carabiner



300092-01
CMC ProSteel Auto-Lock D Gray/Silver
ANSI Carabiner

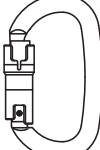

300094-01
CMC ProSteel Auto-Lock Oval Gray/
Silver ANSI Carabiner

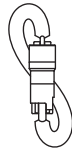

300095-01
CMC/Kong DNA Auto-Lock Gray/Silver
ANSI Carabiner

Dimension	300090-01		300092-01		300093-01		300094-01		300095-01		300096-01	
	mm	in	mm	in	mm	in	mm	in	mm	in	mm	in
	76.5	3.01	76.5	3.01	62	2.44	62	2.44	65	2.56	65	2.56
	114	4.49	114	4.49	110	4.33	110	4.33	108	4.25	108	4.25
	26	1.02	25	0.98	21	0.78	20	0.78	18	0.71	19	0.75

Weight	300090-01		300092-01		300093-01		300094-01		300095-01		300096-01	
	g	oz	g	oz	g	oz	g	oz	g	oz	g	oz
	240	8.5	265	9.3	205	7.2	220	7.8	230	8.1	215	7.6

Strength	300090-01		300092-01		300093-01		300094-01		300095-01		300096-01	
	kN	lbf	kN	lbf	kN	lbf	kN	lbf	kN	lbf	kN	lbf
	48	10,791	48	10,791	40	8,992	40	8,992	40	8,992	40	8,992
	17	3,822	17	3,822	12	2,698	12	2,698	11	2,473	11	2,473
	16	3,597	20	4,496	16	3597	20	4,496	16	3,597	16	3,597
	\	\	16	3,597	\	\	16	3,597	16	3,597	\	\
	\	\	16	3,597	\	\	16	3,597	16	3,597	\	\



MEETS THE CARABINER REQUIREMENTS OF NFPA 1983, INCORPORATED IN THE 2022 EDITION OF NFPA 2500.

- 300090-01 CMC PROSTEEL SCREW-LOCK D GRAY/BRONZE CARABINER, GENERAL USE (G) MBS 48 KN (10,791 LBF)
- 300092-01 CMC PROSTEEL AUTO-LOCK D GRAY/SILVER ANSI CARABINER, GENERAL USE (G) MBS 48 KN (10,791 LBF)
- 300093-01 CMC PROSTEEL SCREW-LOCK OVAL GRAY/BRONZE CARABINER, GENERAL USE (G) MBS 40 KN (8,992 LBF)
- 300094-01 CMC PROSTEEL AUTO-LOCK OVAL GRAY/SILVER ANSI CARABINER, GENERAL USE (G) MBS 40 KN (8,992 LBF)
- 300096-01 CMC/KONG DNA AUTO-LOCK GRAY/SILVER CARABINER, GENERAL USE (G) MBS 40 KN (8,992 LBF)

MEETS THE REQUIREMENTS OF ANSI Z359.12:2019: CONNECTING COMPONENTS FOR PERSONAL FALL ARREST SYSTEMS.

- 300092-01 CMC PROSTEEL AUTO-LOCK D GRAY/SILVER ANSI CARABINER
- 300094-01 CMC PROSTEEL AUTO-LOCK OVAL GRAY/SILVER ANSI CARABINER
- 300095-01 CMC/KONG DNA AUTO-LOCK GRAY/SILVER ANSI CARABINER

Compliance of conformity to ANSI Z359.12:2019 performed by the following notified bodies:

- n° 0123 - TÜV SÜD Product Service GmbH Daimlerstraße 11 - 85748 Garching - Germany (300392 & 300394)
- n° 2008 DOLOMITICERT scarl - zona industriale Villanova - 32013 Longarone (BL) - Italia (300395)

USER INFORMATION

User Information shall be provided to the user of the product. NFPA Standard 1983, incorporated into the 2022 edition of NFPA 2500 recommends separating the User Information from the equipment and retaining the information in a permanent record. The standard also recommends making a copy of the User Information to keep with the equipment and that the information should be referred to before and after each use.

Additional information regarding life safety equipment can be found in NFPA 1500 and NFPA 1858 and NFPA 1983, incorporated in the 2022 edition of NFPA 2500 and the ANSI Z359 series of Fall Protection standards.

LIFESPAN / INSPECTION / RETIREMENT

CMC does not specify an expiration date for hardware because the service life depends greatly on how and where it is used. The type of use, intensity of use, and environment of use are all factors in determining serviceability of the equipment. A single exceptional event can be cause for retirement after one use, such as exposure to sharp edges, extreme temperatures, chemicals, or harsh environments. Remove retired equipment from service and destroy it to prevent further use.

A device must be retired when:

- It fails to pass inspection.
- It fails to function properly.
- It has illegible product markings.
- It shows signs of damage or excessive wear.
- It has been subjected to shock loads, falls, or abnormal use.
- It has been exposed to harsh chemical reagents.
- It has an unknown usage history.
- You have any doubt as to its condition or reliability.
- When it becomes obsolete due to changes in legislation, standards, technique or incompatibility with other equipment.

Inspect the equipment according to your department's policy for inspecting life safety equipment. CMC recommends a detailed inspection by a competent person at least once every 12 months depending on current regulations and conditions of use. Record the date, inspector name, and inspection results in the equipment log as well as any other relevant information to track the usage history.

Before each use, the user should:

- Confirm the device is functioning properly.
- Verify the presence and legibility of the product markings.
- Verify there is no excessive wear or indications of damage such as deformation, corrosion, sharp edges, cracks, or burrs. Minor nicks or sharp spots may be smoothed with emery cloth or similar.
- Check for the presence of dirt or foreign objects that can affect or prevent normal operation such as grit, sand, rocks, and debris.

During each use, the user should:

- Confirm all pieces of equipment in the system are correctly positioned with respect to each other.
- Monitor the condition of the device and its connections to other equipment in the system.
- Do not allow anything to interfere with the operation of the device or its components.
- Keep foreign objects out of the device.

LIMITATIONS AND PROPER USE

All carabiners are designed to specific performance criteria. Be aware of load limitations, manner used, and proper technique. Do not overload a carabiner. Carabiners can fail under improper use conditions such as cross loading, gate open loading, loading other than major axis, applying a shear or torsional load to the carabiner, etc. If you are not sure of proper application or technique, seek proper training in carabiner use and technical rope application.

To remove the keeper pin (for models so equipped), use the supplied hex wrench to remove the set screw, then pull the pin completely from the carabiner frame. To reinstall, insert the keeper pin through the hole in the gate side of the frame, then ensure the pin is fully seated in the blind hole in the spine side of the frame. Reinstall the set screw, taking care not to overtighten or strip the threads or head. Use a thread locker to ensure the set screw does not back out during use.

COMPATIBILITY

300092-01, 300094-01, and 300095-01 are connecting components in accordance with ANSI/ASSP Z359.12-2019, used to connect two or more pieces of equipment together in Personal Fall Arrest Systems. Ensure compatibility with other components in the fall protection system.

CARRYING, MAINTENANCE & STORAGE

During all use, carrying, storage and transport keep the equipment away from acids, alkalis, rust and strong chemicals. Do not expose the equipment to direct heat, flame or high temperatures. Clean equipment using clean fresh water to remove any dust or debris. Do not use a pressure washer for cleaning. If the equipment gets wet, remove excess moisture and allow to air dry at temperatures between 10° C and 30° C. Lubricate moving parts as needed. During storage and transport, protect the equipment from heat, direct sunlight, moisture, chemicals, and external loads or impacts. Do not store where the equipment may be exposed to moist air, particularly where dissimilar metals are stored together.

WARRANTY & REPAIRS

If your CMC product has a defect due to workmanship or materials, please contact CMC Customer Support at info@cmcprou.com for warranty information and service. CMC's warranty does not cover damages caused by improper care, improper use, alterations and modifications, accidental damage or the natural breakdown of material over extended use and time. The equipment should not be modified in any way or altered to allow attachment of additional parts without the manufacturer's written recommendation. If original components are modified or removed from the product, its safety aspects may be restricted. All repair work shall be performed by the manufacturer. All other work or modifications void the warranty and releases CMC from all liability and responsibility as the manufacturer.

SAMPLE INSPECTION AND MAINTENANCE LOG

The following sample log provides an example of the records that can be maintained by the purchaser or user.

Equipment Inspection and Maintenance Log			
Item _____ # _____		Date in Service _____	
Brand/Model _____		Strength _____	
Date	How Used or Maintained	Comments	Name

Screw-Lock Use

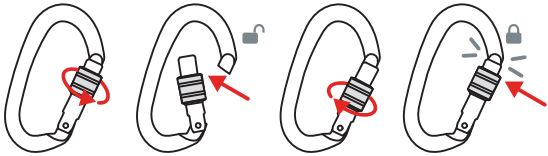

(1)Unscrew gate to unlock (2)Push gate in to open (3)Screw gate to close (4)Confirm gate locking

Auto-Lock Use

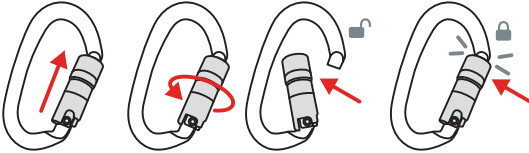

(1)Push gate up (2)Twist gate to unlock (3)Push Gate in to open (4)Release Gate to Lock (5)Confirm Gate Locking

⚠ Do not use if gate fails to lock or open properly.



CMC Rescue, Inc.
6740 Cortona Drive, Goleta, CA 93117, USA
805-562-9120 / 800-235-5741
cmcprou.com
ISO 9001 Certified
© CMC Rescue, Inc. All rights reserved
CMC and **XX** are registered marks of CMC Rescue Inc.
CMC Control No.: 30009X-01IN01_Rev00

NFPA 2500 (2022 ED) “G”

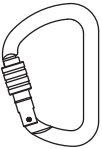

300090-01

CMC ProSteel Screw-Lock D Gray/
Bronze Carabiner

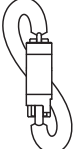

300096-01

CMC/Kong DNA Auto-Lock Gray/Silver
Carabiner

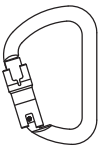

300092-01

CMC ProSteel Auto-Lock D Gray/Silver
ANSI Carabiner

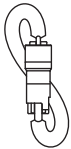

300095-01

CMC/Kong DNA Auto-Lock Gray/Silver
ANSI Carabiner

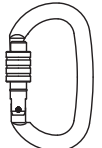

300093-01

CMC ProSteel Screw-Lock Oval Gray/
Bronze Carabiner

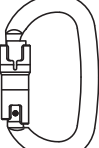

300094-01

CMC ProSteel Auto-Lock Oval Gray/
Silver ANSI Carabiner

Dimension	300090-01		300092-01		300093-01		300094-01		300095-01		300096-01	
	mm	in	mm	in	mm	in	mm	in	mm	in	mm	in
	76.5	3.01	76.5	3.01	62	2.44	62	2.44	65	2.56	65	2.56
	114	4.49	114	4.49	110	4.33	110	4.33	108	4.25	108	4.25
	26	1.02	25	0.98	21	0.78	20	0.78	18	0.71	19	0.75

Weight	300090-01		300092-01		300093-01		300094-01		300095-01		300096-01	
	g	oz	g	oz	g	oz	g	oz	g	oz	g	oz
	240	8.5	265	9.3	205	7.2	220	7.8	230	8.1	215	7.6

Strength	300090-01		300092-01		300093-01		300094-01		300095-01		300096-01	
	kN	lbf	kN	lbf	kN	lbf	kN	lbf	kN	lbf	kN	lbf
	48	10,791	48	10,791	40	8,992	40	8,992	40	8,992	40	8,992
	17	3,822	17	3,822	12	2,698	12	2,698	11	2,473	11	2,473
	16	3,597	20	4,496	16	3597	20	4,496	16	3,597	16	3,597
	\	\	16	3,597	\	\	16	3,597	16	3,597	\	\
	\	\	16	3,597	\	\	16	3,597	16	3,597	\	\

⚠ WARNINGS

Activities involving the use of this equipment are potentially dangerous. Special knowledge and training are required to use this product. You are responsible for your own actions and decisions. Before using this device, you must:

- Read and understand these user instructions and warnings.
- Familiarize yourself with its capabilities and limitations.
- Be a competent person and/or get specific training in its proper use, or be under the direct supervision of a trained or otherwise competent person.
- Understand and accept the risks involved.

FAILURE TO HEED ANY OF THESE WARNINGS MAY RESULT IN SEVERE INJURY OR DEATH.



MEETS THE CARABINER REQUIREMENTS OF NFPA 1983, INCORPORATED IN THE 2022 EDITION OF NFPA 2500.

- 300090-01 CMC PROSTEEL SCREW-LOCK D GRAY/BRONZE CARABINER, GENERAL USE (G) MBS 48 KN (10,791 LBF)
- 300092-01 CMC PROSTEEL AUTO-LOCK D GRAY/SILVER ANSI CARABINER, GENERAL USE (G) MBS 48 KN (10,791 LBF)
- 300093-01 CMC PROSTEEL SCREW-LOCK OVAL GRAY/BRONZE CARABINER, GENERAL USE (G) MBS 40 KN (8,992 LBF)
- 300094-01 CMC PROSTEEL AUTO-LOCK OVAL GRAY/SILVER ANSI CARABINER, GENERAL USE (G) MBS 40 KN (8,992 LBF)
- 300096-01 CMC/KONG DNA AUTO-LOCK GRAY/SILVER CARABINER, GENERAL USE (G) MBS 40 KN (8,992 LBF)

MEETS THE REQUIREMENTS OF ANSI Z359.12:2019: CONNECTING COMPONENTS FOR PERSONAL FALL ARREST SYSTEMS.

- 300092-01 CMC PROSTEEL AUTO-LOCK D GRAY/SILVER ANSI CARABINER
- 300094-01 CMC PROSTEEL AUTO-LOCK OVAL GRAY/SILVER ANSI CARABINER
- 300095-01 CMC/KONG DNA AUTO-LOCK GRAY/SILVER ANSI CARABINER

Compliance of conformity to ANSI Z359.12:2019 performed by the following notified bodies:

- n° 0123 - TÜV SÜD Product Service GmbH Daimlerstraße 11 - 85748 Garching - Germany (300392 & 300394)
- n° 2008 DOLOMITICERT scarl - zona industriale Villanova - 32013 Longarone (BL) - Italia (300395)

USER INFORMATION

User Information shall be provided to the user of the product. NFPA Standard 1983, incorporated into the 2022 edition of NFPA 2500 recommends separating the User Information from the equipment and retaining the information in a permanent record. The standard also recommends making a copy of the User Information to keep with the equipment and that the information should be referred to before and after each use.

Additional information regarding life safety equipment can be found in NFPA 1500 and NFPA 1858 and NFPA 1983, incorporated in the 2022 edition of NFPA 2500 and the ANSI Z359 series of Fall Protection standards.

LIFESPAN / INSPECTION / RETIREMENT

CMC does not specify an expiration date for hardware because the service life depends greatly on how and where it is used. The type of use, intensity of use, and environment of use are all factors in determining serviceability of the equipment. A single exceptional event can be cause for retirement after one use, such as exposure to sharp edges, extreme temperatures, chemicals, or harsh environments. Remove retired equipment from service and destroy it to prevent further use.

A device must be retired when:

- It fails to pass inspection.
- It fails to function properly.
- It has illegible product markings.
- It shows signs of damage or excessive wear.
- It has been subjected to shock loads, falls, or abnormal use.
- It has been exposed to harsh chemical reagents.
- It has an unknown usage history.
- You have any doubt as to its condition or reliability.
- When it becomes obsolete due to changes in legislation, standards, technique or incompatibility with other equipment.

Find the latest version this manual at cmcpro.com

GENERAL USE (G)
NFPA 2500 (1983), 2022 ED.
ANSI Z359.12 (19)

CMC PROSTEEL CARABINERS
CMC/KONG DNA CARABINERS

CMC

Product No. 300096-01
CMC/Kong DNA Auto-Lock Gray/Silver Carabiner

⚠ WARNINGS

Activities involving the use of this equipment are potentially dangerous. Special knowledge and training are required to use this product. You are responsible for your own actions and decisions. Before using this device, you must:

- Read and understand these user instructions and warnings.
- Familiarize yourself with its capabilities and limitations.
- Be a competent person and/or get specific training in its proper use, or be under the direct supervision of a trained or otherwise competent person.
- Understand and accept the risks involved.

FAILURE TO HEED ANY OF THESE WARNINGS MAY RESULT IN SEVERE INJURY OR DEATH.

Inspect the equipment according to your department's policy for inspecting life safety equipment. CMC recommends a detailed inspection by a competent person at least once every 12 months depending on current regulations and conditions of use. Record the date, inspector name, and inspection results in the equipment log as well as any other relevant information to track the usage history.

Before each use, the user should:

- Confirm the device is functioning properly.
- Verify the presence and legibility of the product markings.
- Verify there is no excessive wear or indications of damage such as deformation, corrosion, sharp edges, cracks, or burrs. Minor nicks or sharp spots may be smoothed with emery cloth or similar.
- Check for the presence of dirt or foreign objects that can affect or prevent normal operation such as grit, sand, rocks, and debris.

During each use, the user should:

- Confirm all pieces of equipment in the system are correctly positioned with respect to each other.
- Monitor the condition of the device and its connections to other equipment in the system.
- Do not allow anything to interfere with the operation of the device or its components.
- Keep foreign objects out of the device.

LIMITATIONS AND PROPER USE

All carabiners are designed to specific performance criteria. Be aware of load limitations, manner used, and proper technique. Do not overload a carabiner. Carabiners can fail under improper use conditions such as cross loading, gate open loading, loading other than major axis, applying a shear or torsional load to the carabiner, etc. If you are not sure of proper application or technique, seek proper training in carabiner use and technical rope application.

To remove the keeper pin (for models so equipped), use the supplied hex wrench to remove the set screw, then pull the pin completely from the carabiner frame. To reinstall, insert the keeper pin through the hole in the gate side of the frame, then ensure the pin is fully seated in the blind hole in the spine side of the frame. Reinstall the set screw, taking care not to overtighten or strip the threads or head. Use a thread locker to ensure the set screw does not back out during use.

COMPATIBILITY

300092-01, 300094-01, and 300095-01 are connecting components in accordance with ANSI/ASSP Z359.12-2019, used to connect two or more pieces of equipment together in Personal Fall Arrest Systems. Ensure compatibility with other components in the fall protection system.

CARRYING, MAINTENANCE & STORAGE

During all use, carrying, storage and transport keep the equipment away from acids, alkalis, rust and strong chemicals. Do not expose the equipment to direct heat, flame or high temperatures. Clean equipment using clean fresh water to remove any dust or debris. Do not use a pressure washer for cleaning. If the equipment gets wet, remove excess moisture and allow to air dry at temperatures between 10° C and 30° C. Lubricate moving parts as needed. During storage and transport, protect the equipment from heat, direct sunlight, moisture, chemicals, and external loads or impacts. Do not store where the equipment may be exposed to moist air, particularly where dissimilar metals are stored together.

WARRANTY & REPAIRS

If your CMC product has a defect due to workmanship or materials, please contact CMC Customer Support at info@cmcpro.com for warranty information and service. CMC's warranty does not cover damages caused by improper care, improper use, alterations and modifications, accidental damage or the natural breakdown of material over extended use and time. The equipment should not be modified in any way or altered to allow attachment of additional parts without the manufacturer's written recommendation. If original components are modified or removed from the product, its safety aspects may be restricted. All repair work shall be performed by the manufacturer. All other work or modifications void the warranty and releases CMC from all liability and responsibility as the manufacturer.

SAMPLE INSPECTION AND MAINTENANCE LOG

The following sample log provides an example of the records that can be maintained by the purchaser or user.

Equipment Inspection and Maintenance Log			
Item _____ # _____		Date in Service _____	
Brand/Model _____		Strength _____	
Date	How Used or Maintained	Comments	Name

Screw-Lock Use

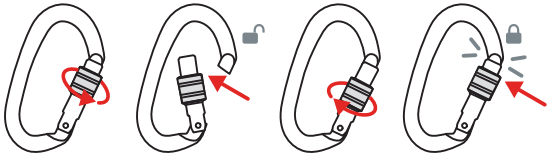

(1)Unscrew gate to unlock (2)Push gate in to open (3)Screw gate to close (4)Confirm gate locking

Auto-Lock Use

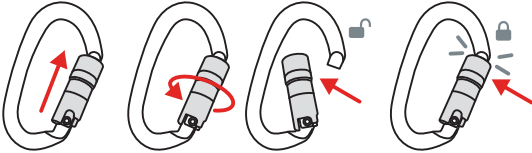

(1)Push gate up (2)Twist gate to unlock (3)Push Gate in to open (4)Release Gate to Lock (5)Confirm Gate Locking

⚠ Do not use if gate fails to lock or open properly.



CMC Rescue, Inc.
6740 Cortona Drive, Goleta, CA 93117, USA
805-562-9120 / 800-235-5741
cmcpro.com
ISO 9001 Certified
© CMC Rescue, Inc. All rights reserved
CMC and **XX** are registered marks of CMC Rescue Inc.
CMC Control No.: 30009X-01IN01_Rev00

NFPA 2500 (2022 ED) “G”

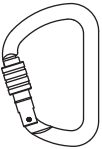

300090-01

CMC ProSteel Screw-Lock D Gray/
Bronze Carabiner

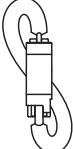

300096-01

CMC/Kong DNA Auto-Lock Gray/Silver
Carabiner

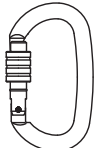

300093-01

CMC ProSteel Screw-Lock Oval Gray/
Bronze Carabiner

NFPA 2500 (2022 ED) “G” AND ANSI Z359.12 (19)

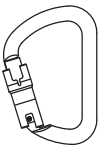

300092-01

CMC ProSteel Auto-Lock D Gray/Silver
ANSI Carabiner

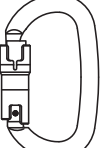

300094-01

CMC ProSteel Auto-Lock Oval Gray/
Silver ANSI Carabiner

ANSI Z359.12 (19)

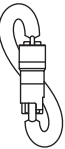

300095-01

CMC/Kong DNA Auto-Lock Gray/Silver
ANSI Carabiner

Dimension	300090-01		300092-01		300093-01		300094-01		300095-01		300096-01	
	mm	in	mm	in	mm	in	mm	in	mm	in	mm	in
	76.5	3.01	76.5	3.01	62	2.44	62	2.44	65	2.56	65	2.56
	114	4.49	114	4.49	110	4.33	110	4.33	108	4.25	108	4.25
	26	1.02	25	0.98	21	0.78	20	0.78	18	0.71	19	0.75

Weight	300090-01		300092-01		300093-01		300094-01		300095-01		300096-01	
	g	oz	g	oz	g	oz	g	oz	g	oz	g	oz
	240	8.5	265	9.3	205	7.2	220	7.8	230	8.1	215	7.6

Strength	300090-01		300092-01		300093-01		300094-01		300095-01		300096-01	
	kN	lbf	kN	lbf	kN	lbf	kN	lbf	kN	lbf	kN	lbf
	48	10,791	48	10,791	40	8,992	40	8,992	40	8,992	40	8,992
	17	3,822	17	3,822	12	2,698	12	2,698	11	2,473	11	2,473
	16	3,597	20	4,496	16	3597	20	4,496	16	3,597	16	3,597
	\	\	16	3,597	\	\	16	3,597	16	3,597	\	\
	\	\	16	3,597	\	\	16	3,597	16	3,597	\	\