

ROPE / CORD / WEB

Check your rope/cord/web carefully after each use to make sure there are no cuts, chafed areas, broken fibers, soft or hard spots, glazed surfaces, discoloration or variations in diameter/width. Stitching should be checked for broken threads. If any of the above are noted, or if the rope/cord/web is subject to shock loads, retire it from service. CMC has numerous rope manuals and guides for additional information regarding rope inspection and maintenance. Refer to CMC's website cmcpro.com for more information about rope/cord/web inspection, maintenance, strengths, and specifications.

WARNING: Removal of protective shrink tubing is not advised as it protects the stitching and label from premature wear. Removal could jeopardize user safety and product conformance to applicable standards.

CARRYING, MAINTENANCE & STORAGE

During all use, carrying, storage, and transport keep the equipment away from acids, alkalis, exhaust emissions, rust and strong chemicals. Do not expose the equipment to direct heat, flame, or high temperatures or other adverse environmental conditions. If the equipment becomes soiled, it can be washed in cold water with a mild detergent that is safe for use with nylon and polyester. Rinse thoroughly. Do not use a pressure washer. Air dry in temperatures between 10° C and 30° C. Do not dry the equipment in direct sunlight or using an automatic dryer. Lubricate moving parts as needed. During storage and transport, protect the equipment from heat, direct sunlight, moisture, chemicals, and external loads or impacts. Do not store where the equipment may be exposed to moist air, particularly where dissimilar metals are stored together. Consult with the manufacturer in case of any doubt.

WARRANTY & REPAIRS

If your CMC product has a defect due to workmanship or materials, please contact CMC Customer Support at info@cmcpro.com for warranty information and service. CMC's warranty does not cover damages caused by improper care, improper use, alterations and modifications, accidental damage or the natural breakdown of material over extended use and time. All repair work shall be performed by the manufacturer. All other work or modifications void the warranty and releases CMC from all liability and responsibility as the manufacturer.

SAMPLE INSPECTION AND MAINTENANCE LOG

The following sample log provides an example of the records that should be maintained by the purchaser or user of life safety equipment.

EQUIPMENT INSPECTION AND MAINTENANCE LOG			
Item _____ # _____		Date in Service _____	
Brand/Model _____		Strength _____	
Date	How Used or Maintained	Comments	Name

XC CMC™

ESCAPE ARTIST™ SYSTEM

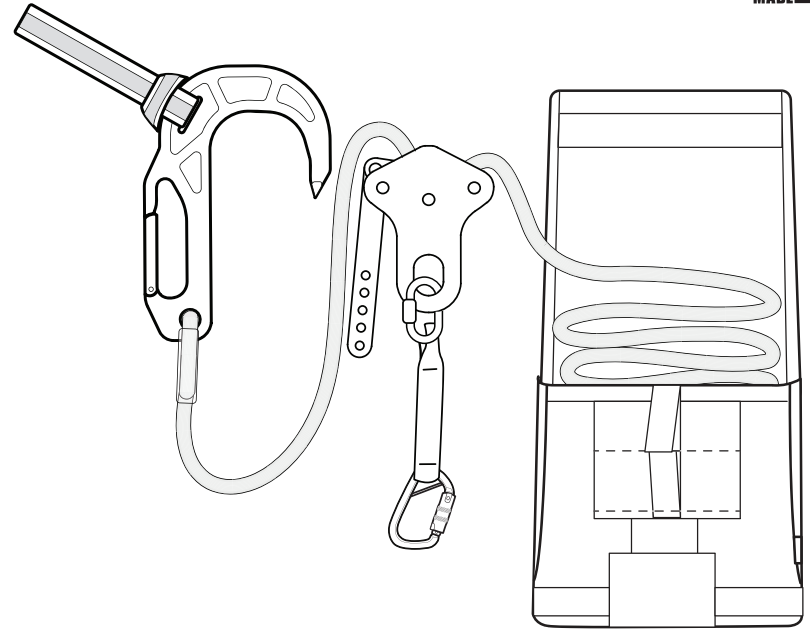

CMC Rescue, Inc.
6740 Cortona Drive
Goleta, CA 93117, USA
805-562-9120 / 800-235-5741
cmcpro.com

ISO 9001 Certified

© CMC Rescue, Inc. All rights reserved

CMC and **XC** are registered marks of CMC Rescue Inc.
CMC Control No.: 5003X0-02IN01_Rev00

⚠ WARNINGS

Activities involving the use of this device are potentially dangerous. You are responsible for your own actions and decisions. Before using this device, you must:

- Read and understand these user instructions, labels, and warnings.
- Familiarize yourself with its capabilities and limitations.
- Obtain specific training in its proper use.
- Understand and accept the risks involved.

FAILURE TO HEED ANY OF THESE WARNINGS MAY RESULT IN SEVERE INJURY OR DEATH.



MEETS THE FIRE ESCAPE SYSTEM REQUIREMENTS OF NFPA 1983, INCORPORATED IN THE 2022 EDITION OF NFPA 2500.

DO NOT DISASSEMBLE.

- 500300-02 CMC ESCAPE SYSTEM W/ ROPE
- 500330-02 CMC ESCAPE SYSTEM W/ WEBBING



Find the latest version of this manual at cmcpro.com
Manual refers to multiple product configurations.

ESCAPE ARTIST



MEETS THE DESCENT CONTROL DEVICE REQUIREMENTS OF NFPA 1983, INCORPORATED IN THE 2022 EDITION OF NFPA 2500.

- 300913-01 CMC ESCAPE ARTIST, RATED FOR ESCAPE USE (E), Ø 7.5 MM

THIS DESCENT CONTROL DEVICE HAS PASSED THE MANNER OF FUNCTION AND HOLDING LOAD TESTS USING THE FOLLOWING ROPE:

- CMC PROSERIES ESCAPE LINE, CMC PN 292015, MFG TEUFELBERGER FIBER ROPE CORP, Ø 7.5 MM

THIS DESCENT CONTROL DEVICE HAS PASSED THE MANNER OF FUNCTION AND HOLDING LOAD TESTS USING THE FOLLOWING ESCAPE WEBBING:

- CMC FIRE ESCAPE WEB, CMC PN 200517-01, MFG CMC RESCUE, PERIMETER 30.0MM

USER INFORMATION

User Information shall be provided to the user of the product. NFPA Standard 1983, incorporated into the 2022 edition of NFPA 2500 recommends separating the User Information from the equipment and retaining the information in a permanent record. The standard also recommends making a copy of the User Information to keep with the equipment and that the information should be referred to before and after each use.

Additional information regarding life safety equipment can be found in NFPA 1500 and NFPA 1858 and NFPA 1983, incorporated in the 2022 edition of NFPA 2500.

LIFESPAN / INSPECTION / RETIREMENT

The service life of equipment depends greatly on the type of use, intensity of use, and the environment of use. CMC does not specify an expiration date for hardware because the service life depends greatly on how and where it is used. For softgoods including Fire Escape Web and escape line, CMC has set a lifespan of 10 years from the date of manufacture shown on the product label.

A single exceptional event can be cause for retirement after only one use, such as exposure to sharp edges, extreme temperatures, chemicals, or harsh environments. Any concerns about its safe use is cause for retirement. Remove retired equipment from service and destroy it to prevent further use.

A device must be retired when:

- It fails to pass inspection.
- It fails to function properly.
- It has illegible product labels or markings.
- It shows signs of damage or excessive wear.
- It has been subjected to shock loads, falls, or abnormal use.
- It has been exposed to harsh chemical reagents.
- It has an unknown usage history.
- You have any doubt as to its condition or reliability.
- When it becomes obsolete due to changes in legislation, standards, technique or incompatibility with other equipment.

Inspect the equipment according to your department's policy for inspecting life safety equipment. CMC recommends a detailed inspection by a competent person at least once every 12 months depending on current regulations and conditions of use. Record the date, inspector name, and inspection results in the equipment log as well as any other relevant information to track the usage history.

When inspecting the system, follow the manufacturer's recommendations for inspection provided with each of the Escape Artist System components. If the system is used in actual fire ground emergency escape, or if there is any doubt about the serviceability of the system, remove the system from service and destroy it.

Before each use, the user should:

- Confirm the equipment is functioning properly.
- Verify the presence and legibility of the product labels and markings.
- Check soft components for cuts, worn or frayed areas, broken fibers, soft or hard spots, discoloration, or melted fibers. Check the stitching for pulled threads, abrasion, or breaks.
- Check hard components for excessive wear or indications of damage such as deformation, corrosion, sharp edges, cracks, or burrs. Minor nicks or sharp spots may be smoothed with emery cloth or similar.
- Check for the presence of dirt or foreign objects that can affect or prevent normal operation such as grit, sand, rocks, and debris.

During Each Use, the user should:

- Confirm all pieces of equipment in the system are correctly positioned with respect to each other.
- Monitor the condition of the equipment and its connections to other equipment in the system.
- Do not allow anything to interfere with the operation of the equipment or its components.
- Prevent foreign objects from interfering with moving parts.

LIMITATIONS AND PROPER USE

The Escape Artist is designed to be used as an Escape Descent Control Device and is only certified for use with 7.5 mm escape line and CMC FR Escape Web. Use only locking carabiners with the Escape Artist to prevent roll out. Verify that carabiners gates are closed and locked prior to use.

Threading the rope/web: The escape rope/web must be pre-rigged into the Escape Artist so that it is ready for use when needed. A diagram for reeving the rope through the device is permanently marked on the side plate. It is essential to the function of the Escape Artist that the rope/web be correctly reeved.

Practice is Essential: Safe use of the Escape Artist requires familiarity with its operation and basic rappel skills. CMC strongly recommends training from a competent instructor and practice in both descending with the Escape Artist and in exiting windows. Always use a backup belay when training.

Exiting the Structure: The Escape Artist is designed to allow both hands to be used to exit a window or other opening in the structure. A safe descent requires a moderate amount of pre-planning with time to set a secure anchor, remove any edge material that may damage the escape rope/web, and to make sure the connector, Escape Artist, and any other equipment clears the edge without damage or hanging up. Fully engaging the handle will provide for maximum payout capability prior to exiting the structure.

Descending: Start by loading the system with your body weight. One hand must grasp the untensioned (running) end of the rope/web (similar to rappelling with a Figure 8 device), while the other hand grasps the control lever. Slowly squeeze the control lever towards the connector hole to initiate your descent. Control the rate of descent by varying the amount of grip applied to the running end of the rope/web, as well as varying the amount of pressure on the control lever. To stop descending, release the lever and tighten the grasp on the free end of the rope. Fully squeezing the control lever will cause a rapid descent. The control lever must be released to stop the descent.

ESCAPE ARTIST SYSTEM - ROPE

SYSTEM COMPONENTS

- CMC Escape Artist (300913)
- Flash.2 Escape Anchor (300983-02) or Flash.G Escape Anchor (300973-01)
- CMC 7.5mm ProSeries Escape Line (292015) with CMC factory sewn termination
- CMC Fire Escape Tether Assembly (203500-01)

USING THE ESCAPE SYSTEM WITH ROPE

For proper deployment of the Escape Artist System, refer to the included User Information for the Escape Artist, Flash Escape Anchor, ProTech Carabiner and 7.5mm ProSeries Escape Line.

The system can be connected to the user's belt or harness using the included tether, or the tether can be removed and the Escape Artist can be connected directly to the belt or harness using just the ProTech Carabiner. When re-packing the system into the supplied CMC Escape Bag or Lumbar Pack, stuff the rope into the main pouch to minimize twisting during deployment. Also make sure that the Flash Escape Anchor and Escape Artist are properly stowed in their respective holders and will deploy freely.

If storing the Escape Artist System directly in the bunker pants pocket or using a different external bag than the supplied CMC Escape Bag or Lumbar Pack, ensure that the rope is properly stuffed and the hardware is packed such that it will deploy freely.

To view a video with more information and detailed instructions on properly packing the Escape Artist System, please visit cmcp.com.

ESCAPE ARTIST SYSTEM - WEB

SYSTEM COMPONENTS

- CMC Escape Artist (300913-01)
- Flash.2 Escape Anchor (300983-02) or Flash.G Escape Anchor (300973-01)
- Fire Escape Web (200517-01) with CMC factory sewn termination
- CMC Fire Escape Tether Assembly (203500-01)

USING THE ESCAPE SYSTEM WITH WEB

For proper deployment of the Escape Artist System, refer to the included User Information for the Escape Artist, Flash Escape Anchor, ProTech Carabiner and Fire Escape Web.

The system can be connected to the user's belt or harness using the included tether, or the tether can be removed and the Escape Artist can be connected directly to the belt or harness using just the ProTech Carabiner.

When re-packing the system into the supplied CMC Escape Bag or Lumbar Pack, stuff the web into the main pouch to minimize twisting during deployment. Also make sure that the Flash Escape Anchor and Escape Artist are properly stowed in their respective holders and will deploy freely.

If storing the Escape Artist System directly in the bunker pants pocket or using a different external bag than the supplied CMC Escape Bag or Lumbar Pack, ensure that the web is properly stuffed and the hardware is packed such that it will deploy freely.

To view a video with more information and detailed instructions on properly packing the Escape Artist System, please visit cmcp.com.